

*anc components*

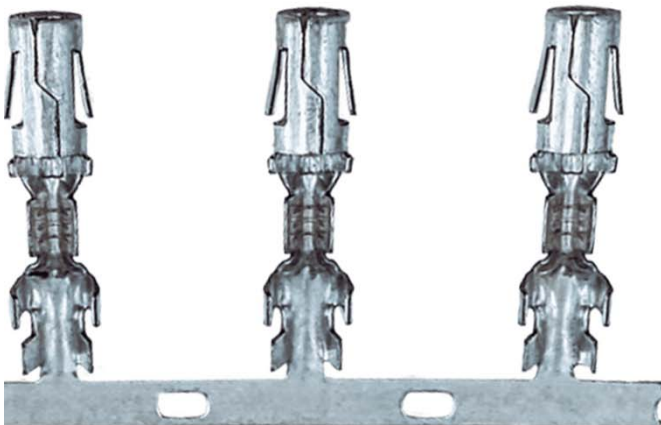
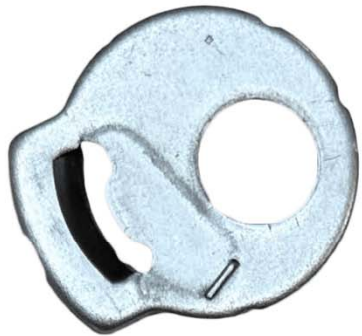

Fineblanking  
High speed stamping  
Robotic welding

# BASIC DATA

**anc components**

Main activity:

**Stamping and forming of precise metal parts**

Company name: ANC COMPONENTS, s.r.o.

Established: 2006

Address: Nabrezi 737, Prstne, Zlin, CZ

www: [anccomponents.cz](http://anccomponents.cz)

Infrastructure:

properties owned by the company

Basic capital:

1 000 000 CZK

Owners:

Ing. Petr Sedláček

Dušan Jurkovič

Number of employee:

60 // 20% management / 10% quality

Shifts:

3 shifts, 5 days / a week

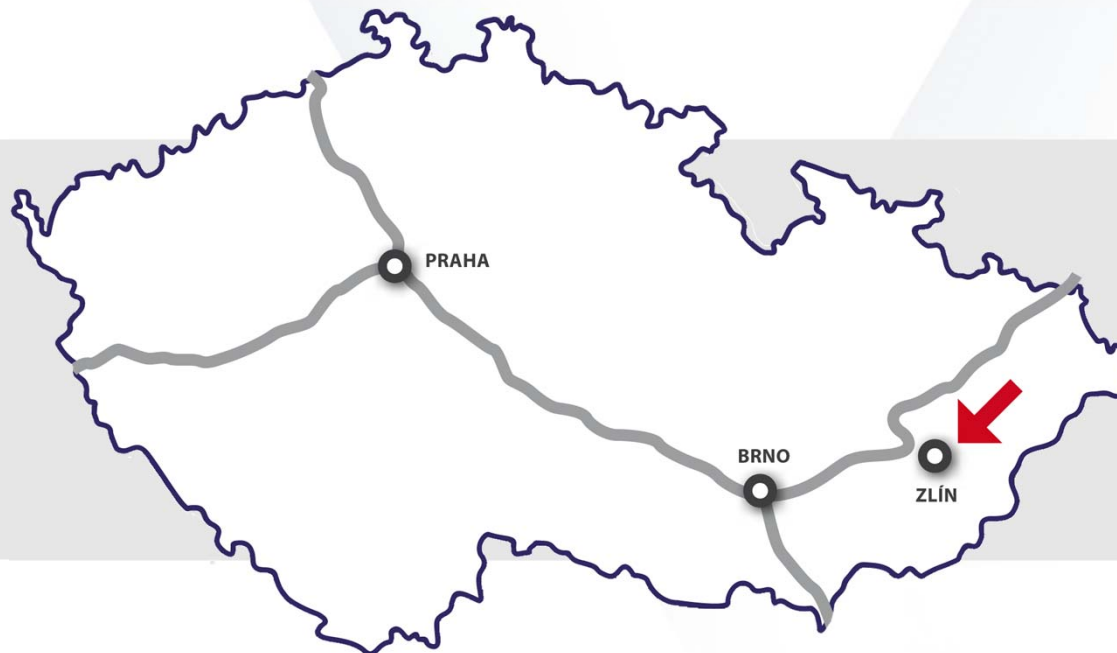

**Connection to  
motorway network  
make logistics and  
business contacts  
easier**

# WE PRODUCE FOR

***anc components***

- automotive industry 43%
- building and agricultural machines 17%
- electrotechnical industry 13%
- white goods equipment 14%
- energetics 5%
- others 9%

## Turnover in mil. Eur

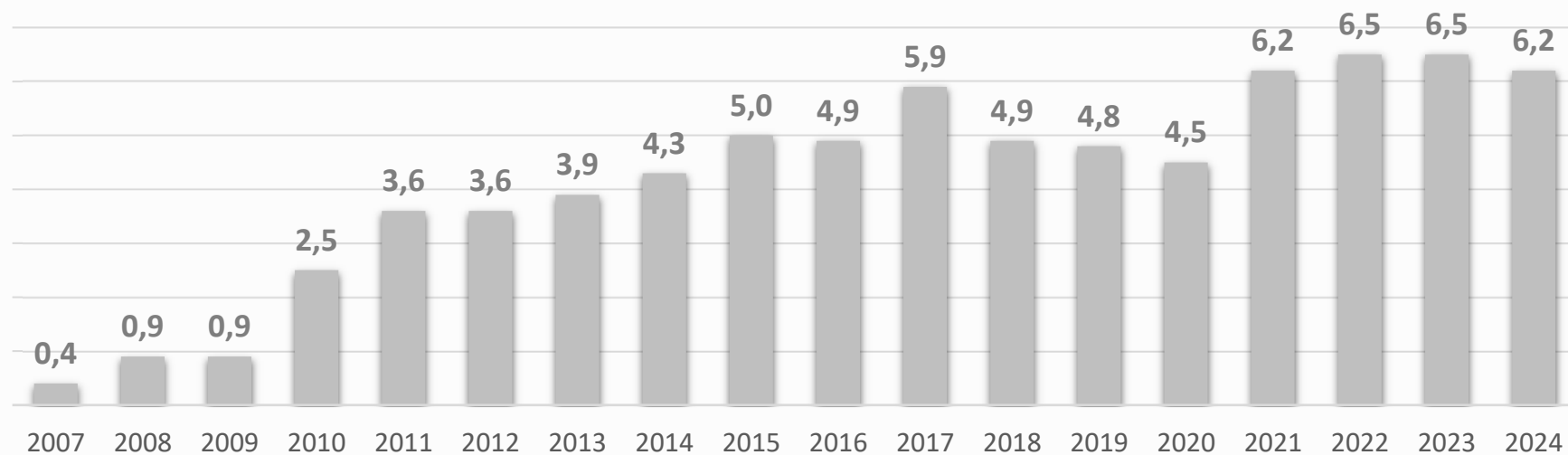

**Turnover in 2024: 6,2 mil. Eur**

# OUR STRENGTH

***anc components***

**FLEXIBILITY  
+  
STABLE TEAM  
+  
STRONG IS/IT**

## **Our strong points:**

- simple organization structure, owners are a part of the working team
- we are creative in finding solutions for demanding tasks
- strong and stable team of technicians
- universal IS supports effectivity and quick access to information
- certified management system

## **Benefits for you:**

- ⇒ quick, qualified decision making
- ⇒ fulfilment of specific customer requirement
- ⇒ stable deliveries
- ⇒ professional partnership
- ⇒ quality guarantee

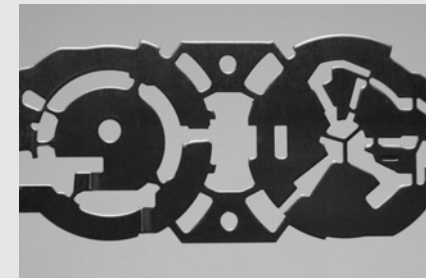
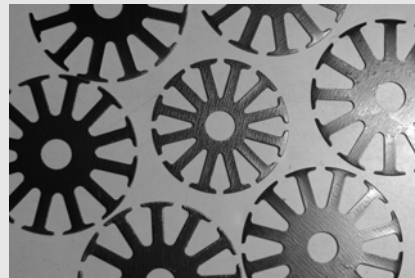



Quality management according to **IATF 16949**.

Certified by **TÜV SÜD**. The 5th recertification successfully passed in 2024.

We emphasize **software support of quality, automatization and reports digitalization**.

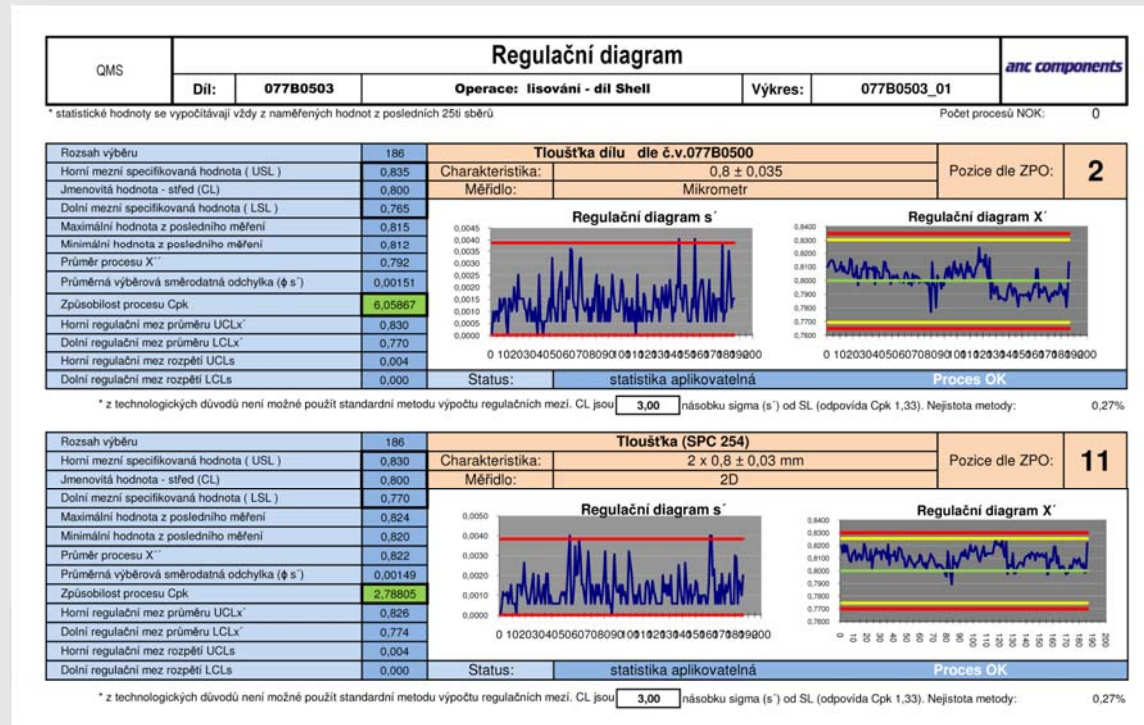

# TECHNICAL PREPARATION OF PRODUCTION

**anc components**

We minimize risks for customers.

**Maximum attention** is given to the preparation phase of new projects. Procedures and tasks are standardized, described and fully controlled.

We cooperate on part design development.

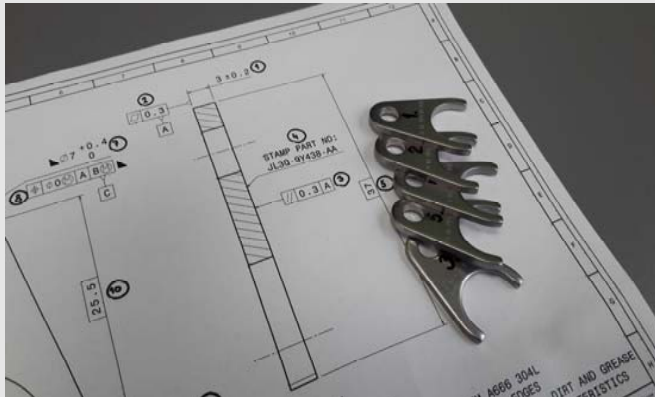

Risk management: feasibility, checkability, deliveries

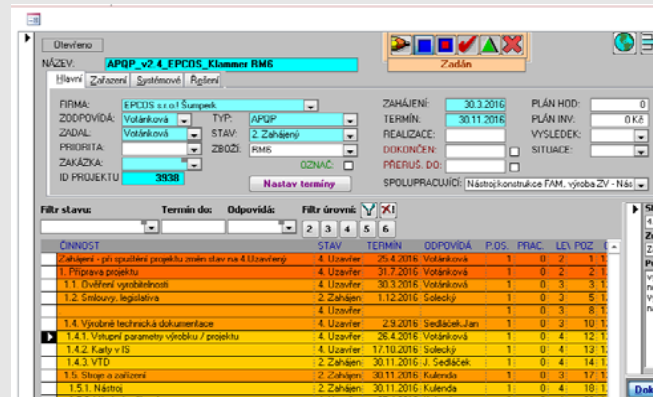

Software support for new project management



APQP standard implemented

# TECHNOLOGICAL CAPACITY

**anc components**

## Internally:

- precise cutting
- high speed stamping
- conventional stamping
- deburring, washing, grinding, passivation
- bending, packets production, flattening, milling, 100% or camera control

## Supplied:

- surface treatment
- heat treatment
- thread production





# PRECISE CUTTING

**anc components**

- Feintool XFT Speed 250 | Feintool GKP 250  
Feintool HFA 400 | Feintool HFA 630 |  
Feintool MFA 160  
tonnage: 160 – 630 t

- material thickness: 1 - 10 mm
- stamping speed: 20 – 100 strokes/min
- air blow-off removal or mechanical removal arm
- straightening devices: 7 - 21 rollers



Chip machining substitution

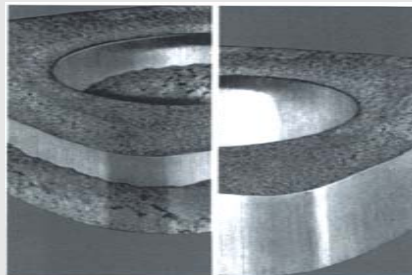

Cutting surface cleanliness



Stainless steel processing

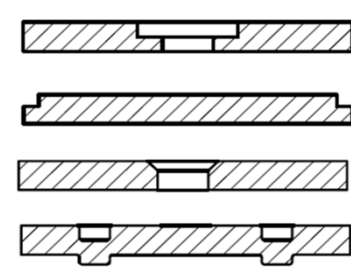

Volumetrical material forming



# HIGH SPEED STAMPING

*anc components*

- Bruderer BSTA 500 | Bruderer BSTA 41  
Bruderer BSTA 25 | Bruderer BSTA 50HL  
tonnage: 25 – 50 t
- material thickness: 0,2 – 2,5 mm
- stamping speed: 100 – 850 strokes/min
- tool and process securing : light barrier, thickness
- possibility to integrate camera control
- part transfer: slump, slide, spool winding

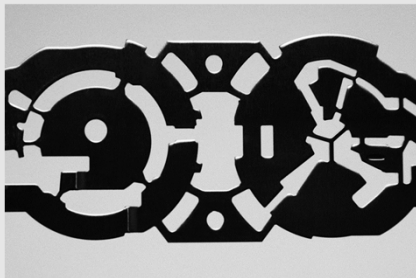

tolerantly and shape demanding parts

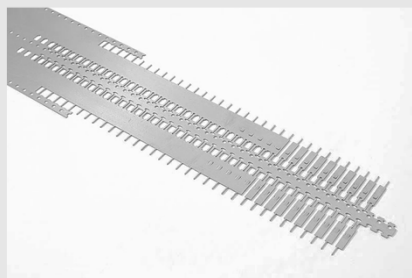

practically verified max. speed: 800 strokes / min



rotor plates with collecting drain



process stability

# PROCESSED RAW MATERIAL

**anc components**

- hot and cold rolled low-carbon steel:  
DD11, DD13, DC01, DC04, S235JR
- micro-alloyed steel with medium and higher carbon content: 16MnCr5, 25CrMo4, 42CrMo4, C60S, C67S, C75S, C60S, 51CrV4
- deep-drawn steel: DX51, S250GD, S350GD  
+ galvanic zinc
- stainless steel: 1.4301, 1.4307, 1,4016, 1.4310

## Non-ferrous metals:

- copper
- copper alloys: CuZn37, CuSn6, CuNi18Zn20  
+ zinc-plated
- aluminium: ALMg3

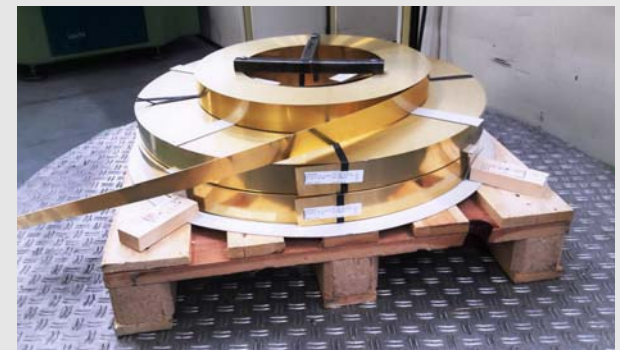

# SECONDARY OPERATION

*anc components*

## Belt grinding:

- roughness requirements is achieved
- parts are fixed: magnetic or by a special template for stainless steel materials
- 4 stations: roughing, finishing, edge deduction, polishing
- one or both side grinding

## Milling:

- CNC controlled
- milling of different shape elements: pockets, slots, blanked holes

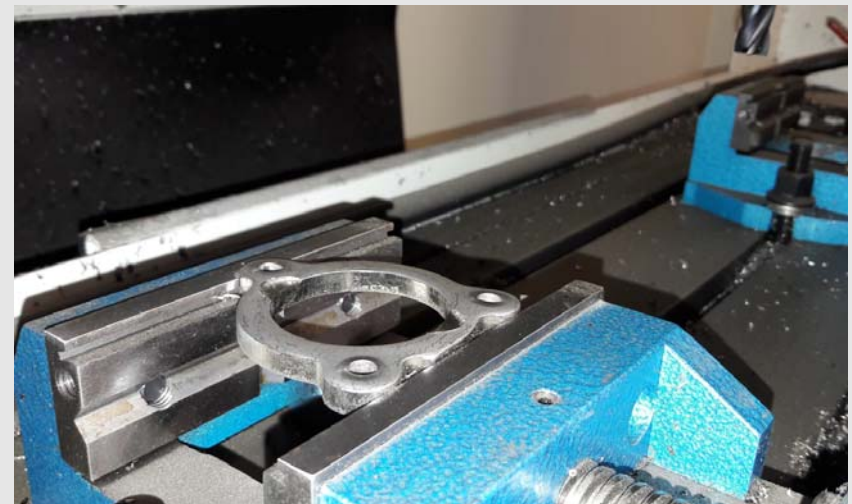



# TOOL SHOP

*anc components*

- stable team
- all shifts are covered
- fully equipped for ordinary maintenance
- design and production of new tools
- experience with relocation and optimization of tools

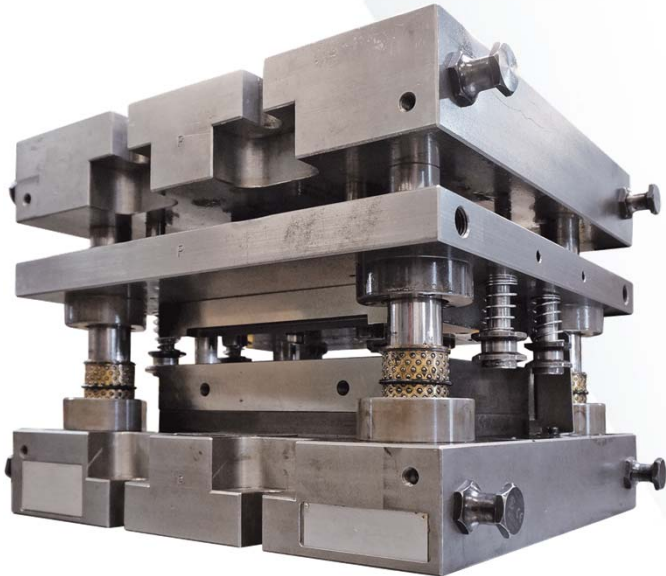



# CONTROLLING LABORATORY

**anc components**

- measurement: length dimensions, roughness, hardness, geometrical tolerances, tothing
- 3x 2D device: Keyence, Baty
- 1x 3D device: Scheffeld
- air-conditioned laboratory
- statistical control of processes
- camera control: detection of thread presence

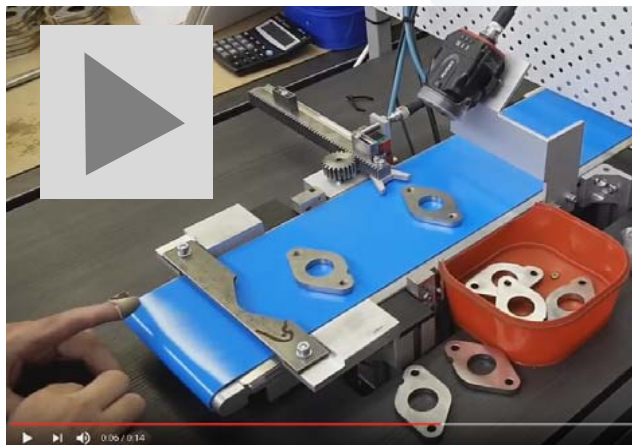

# OUR VISIONS

*anc components*

We are constantly developing. We have a clear conception where we want to be within one, two, five years.

**The nearest future will bring us the following:**

- 100% camera-check line installation
- welding robotic cell installation
- production productivity increase

